

Endorsement on Back

Lebanon County John Smiley (part)
 5^{ac} 136^{pc} & allow. Patented May 10,
 1877, to Amos Wolf Trustee of the
 Lutheran Congregation of Saddy
 Zahns Church. H. 74.30.

Accepted Jan 31st 1877.
 No. 978.

Received Jan 31st 1877.

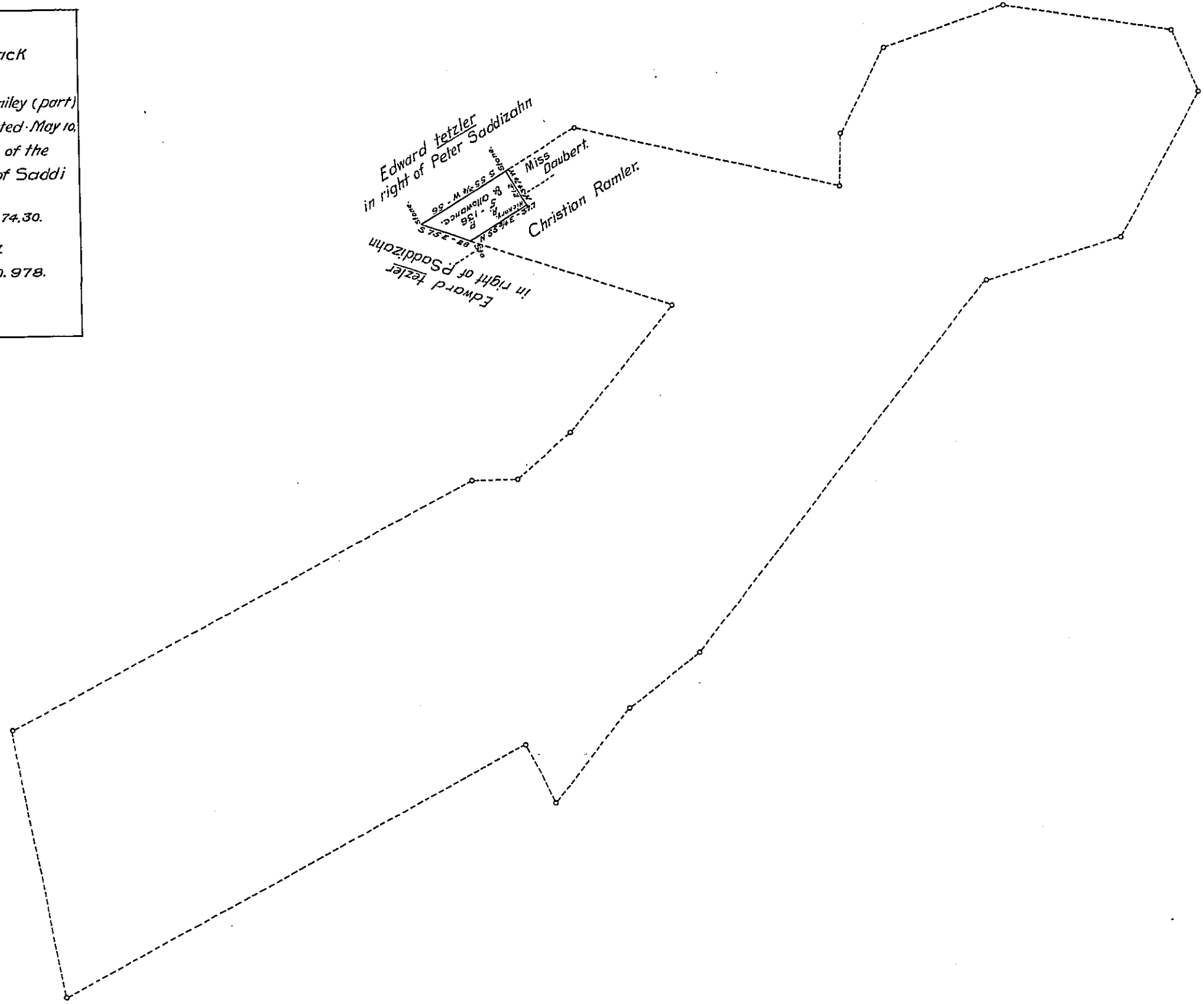

A. Draft of a Tract of Land Situate in the Township of Union County of Lebanon Containing 5 acres and 136 Perches and allowance of Six per Cent for roads
 &C. Surveyed for Amos Wolf Trustee for the Lutheran Congregation of Saddy Zahns Church in Said Township the 26th day of December 1876 it being a part of a Larger Tract of 705
 acres and 150 perches and the Allowance of Six per Cts for roads &C. Originally Surveyed in pursuance of a Warrant Granted to John Smiley dated the 25th day of October 1774.
 To William M^c Candless
 Secretary of internal affairs

Martin Meily C.S.
 for Lebanon County.

I hereby Certify that the foregoing is a Correct Copy of a Survey filed among the records of the County Surveyers office Martin Meily C.S. for Lebanon County.

In Testimony, That the above is a copy of the original remaining on file in the Department of Internal Affairs of Pennsylvania, made conformably to an Act of
 Assembly approved the 16th day of February, 1833, I have hereunto set my Hand and caused the Seal of said Department to be affixed at Harris -
 burg the first day of September 1910.

Henry Houck
 Secretary of Internal Affairs.